

**2025 Brand-new
SUNSEEKER 90 Ocean
9392590**





Model: 2025 Sunseeker 90 Ocean
Length: 27.10m
Beam: 7.16m
Draft: 1.94m
Displacement: 82,300kg

Engine: Twin MAN V12 1900 (2 x 1900PS)
Fuel Capacity: 13,000L
Water Capacity: 1,500L
Max Speed: 27 Knots
Cabins: 4

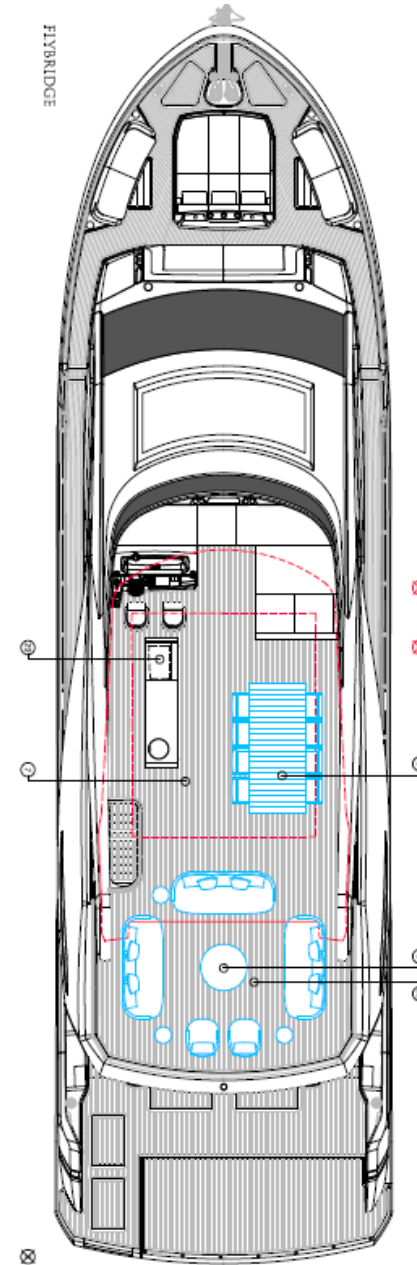
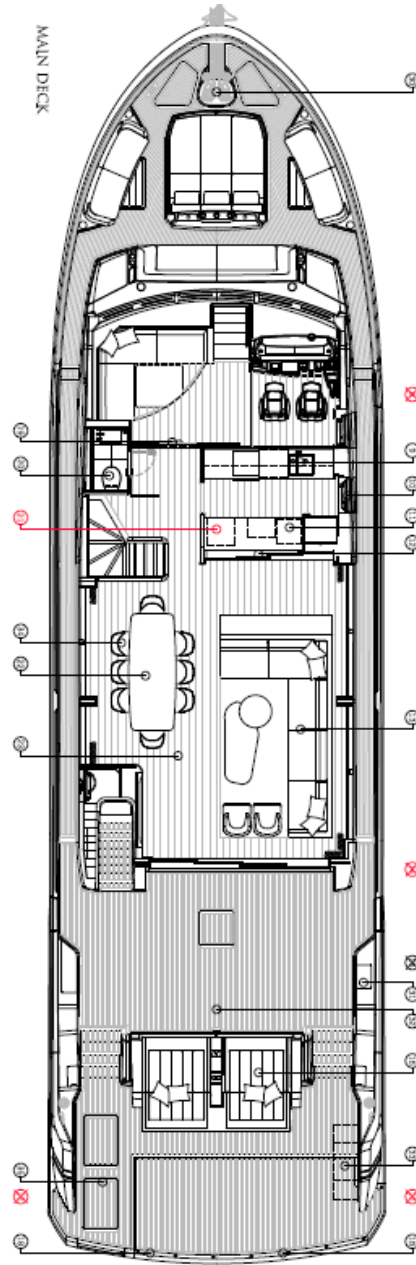
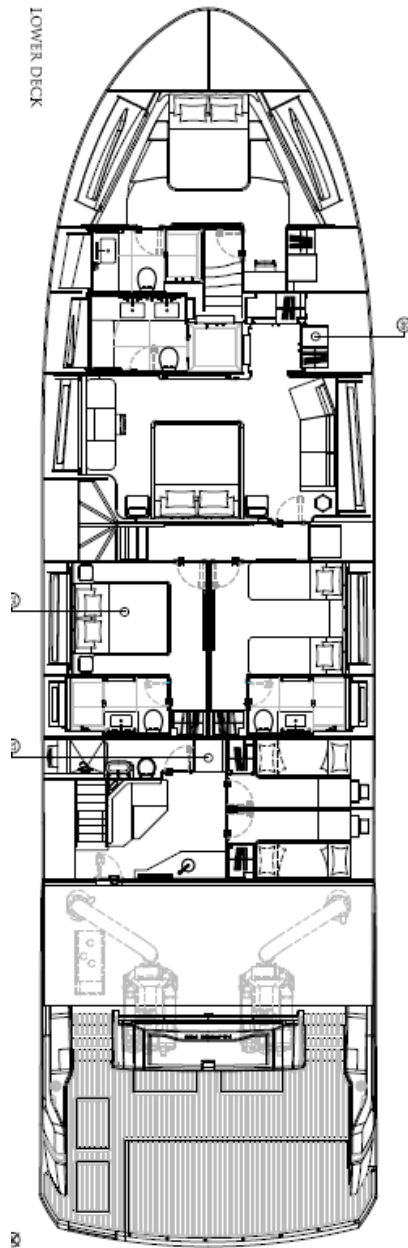

EXTERIOR

















SALOON













MASTER STATEROOM



MASTER STATEROOM



LOWER HELM













Engine

Twin MAN V12 1900 (2 x 1900PS)

Packages

Platinum Mediterranean Package

"Flybridge hardtop, including retractable centre canopy and aft extending sun canopy.

Air Conditioning chilled water system to Tropical specification.

Upgraded both generators from 29 to 35kW.

Second shore power connection.

Hydraulic Sloop stern thruster system.

Twin anchor windlass arrangement with stainless steel anchor and chain.

Fuel polishing system.

Oil change transfer pump.

Additional under counter Custom Galley Refrigeration.

Two stainless steel drawer refrigerators on the flybridge.

Marine Electric ceramic direct cooktop with fold out work stations.

Dimmable Vimar Lighting switching on all overhead lighting.

Teak Decking on the flybridge.

Pair of Retractable Cleats for tender on the platform.

Sprung mattress for all cabin beds.

Layout Options

Bulkhead and sliding door required between galley entrance and helm & observation area. Please refer to GA for layout. Day head orientation to switch to allow for placement of day head door to be moved accordingly.

Main deck day head in lieu of standard cloakroom

Port side dining table to be full Quartz Stone Top. Finish to be Calcutta Gold- polished. In lieu of the smoked eucalyptus high sheen satin finish with stainless steel detail.

Standard saloon layout with L shaped saloon seating, two loose chairs and coffee table. Dining table with 8 chairs to starboard and chaise longue to port

Alternative saloon layout with L shaped extended saloon seating and two loose chairs with and coffee table. Dining table with 8 chairs to port

Add grounding plate with internal stud for dealer to connect when converting the yachts electrics to meet the new Australian electrical

8 x Robert Langford Washington Dining Chairs to be supplied in lieu of the Robert Langford Lauderdale Dining Chairs.

Enclosed Galley option with inboard access door and opaque sliding bar shutter.

Two Porta Romana Scruffy Ribbon Wall Lights in Decayed Silver TWL49. 6 1/2" Open Back Oval Shade in Putty Silk with Cream Card Lining. In lieu of the standard Covex Wall Lights.

1 x Porta Romana Small Nash Lamp fitted to the outboard end of the low level unit in the saloon area. Shade to be 13" Low Hat in Natural Linen with Cream Card Lining.

This is in lieu of the standard 2 x Bishop Lamps.

All cabin blinds to have black out lining added.

Sofa arrangement on the starboard side in the Master Stateroom

Additional Double Socket to be fitted to the inside of the main cabin lobby starboard side storage cabinet.

Master Ensuite and Forward VIP Ensuite to have upgraded Porcelain applied to the shower bulkheads.

Saloon Low Level Storage Unit top to be upgraded to quartz in lieu of the standard Minerva.

Saloon blinds to be electric privacy rollers in lieu of the standard venetian blinds.

Galley Forward Backsplash to be finished in Quartz - Vanilla Noir - Polished. In lieu of the standard brushed stainless steel.

Complete Set of Anodes to be supplied loose onboard the boat.

All interior sockets to have local switch controls. All sockets to be universal in lieu of standard euro 2 pin. As per presentation.

Wood flooring options

Wood flooring in Saloon, dining and forward observation and helm

Interior Wood Finish

Interior Wood Finish - Smoked eucalyptus figured high sheen satin finish

Safe options

Safe concealed in cabinetry (24.5 lbs. W360mm x H190mm x D410mm) for the Master Stateroom

Door Locks

Snib Locks to be fitted to all cabin doors.

Crockery, Cutlery and Glassware

Yacht Crockery to consist of Wedgwood white. Consisting of 10x dinner plates, 10x side plates, 10x soup bowls, 10x cups and saucers. 1x Teapot, 1x Cream/milk jug, 1x sugar bowl and 1x salt and pepper pot.

Yacht Cutlery to Consist of Robert Walsh. Comprising of 10x dinner knives, 10x dinner forks, 10x desert spoons, 10x soup spoons, 10x teaspoons and 4x serving spoons

Yacht Glassware to consist of Dartington Crystal 10x Double Dimple Old Fashioned Tumbler TU10/5/P. 10x Elegance Champagne Flute SP410.

Crew Crockery to consist of Wedgwood Cannaught White. Consisting of 6x dinner plates, 6x side plates, 6x soup bowls, 6x mugs

Crew Cutlery to Consist of Robert Walsh Facet Bright. Comprising of 6x dinner knives, 6x dinner forks, 6x desert spoons, 6x soup spoons, 6x teaspoons and 2x serving spoons

Tinting of windows

Dark Tinted film to side windows and sliding doors

Cabin beds

All exterior cushion and furniture covers to be supplied in Sunbrella Plus in lieu of the standard valmex.

Foam mattress for all cabin beds

Heirlooms bedlinen to be supplied in all cabins and the crew cabin

Starboard guest cabin to be configured with two fixed single berths.

Starboard guest cabin to be configured with fixed Double berth.

Port guest cabin to be configured with two fixed single berths.

Port guest cabin to be configured with fixed Double berth.

Main Deck Glazing

Main Deck Saloon full height glass on the port side. No sliding doors.

Main Deck Saloon full height glass on the starboard side. No sliding doors.

Fixed glazed Galley - no openings

Galley pantograph style access door to the side deck

Exterior Engineering

Hydraulically lifting platform with maximum Tender weight of 750 kg

Hydraulic Retractable Passerelle / bathing ladder in stainless steel with teak walkway

None Hard top boat to have the standard flybridge radar arch

Paint all navigation equipment on hard top and radar mast in Black LSAPaint. (No warranty on the navigation equipment)

Anchoring

Single Lewmar V8 24 Volt DC Windlass. Vertical Gypsy and Capstan drum. Manual hand wheel brake and Devils Claw chain stopper.

One Lewmar 80kg galvanised Claw anchor.

100 meters of 12mm high tensile galvanised short link chain with anchor swivel.

Stern capstan winches - two Lewmar C4 24 Volt DC vertical capstans fitted port and starboard

Mooring Bollards in polished stainless steel fitted port and starboard in fore deck and aft main deck with fairleads.

Spring cleats x two sets in polished stainless steel fitted port and starboard on bulwark.

Exterior Options

Antifouling application - Seajet 117 epoxy primer and Seajet 034 Emperor White self polishing Antifoul

Antifouling application - Seajet 117 epoxy primer and Seajet 033 Shogun Black self polishing Antifoul

Polished stainless steel ensign staff suitable for 2.5 yard ensign

Carbon fibre companionway hatch at top of stairs from aft cockpit to flybridge deck

Radar chair and light mast colour option

Spradling Hitch premium exterior upholstery upgrade

Exterior Options Aft Deck

X-Tend sun-lounger. The platform forward locker doors to fold out electrically exposing two large sun-loungers. Alternatively the doors can fold up forming aft deck sun-loungers thus extending the cockpit space with the stern glazed safety rails bi-folding to the side.

Aft deck seating cushions for standard option. Coco Wolf furniture

Exterior Options Fore Deck

Fore deck seating cushions with standard fixed sunbed

Exterior Options Flybridge Layout

Flybridge Standard. Forward observation sun lounger

Flybridge optional open plan forward observation area with coffee table

Preparation only for the future fitment of the spa tub on the aft flybridge deck. Hot and Cold water feed, power supply and drainage pipework.

Flybridge forward screen seating cushions with standard fixed sunbed

Exterior Options Flybridge Bar Options

Flybridge Wetbar mouldings and doors spray paint finished

Aft deck Console Bar Options

Additional Lower Cockpit storage console bar moulding and doors finished in standard white gelcoat.

Additional Lower Cockpit storage console bar moulding and doors finished in spray paint finished

Campers and covers

Rear Camper with windows

Flybridge Instrument Cover

Windscreen Cover

Fore Deck Covers Package - Foredeck seating, sunpad and table covers.

Flybridge Covers Package - Flybridge seating, sunpad, table and helm seat covers.

Parasol with offset post with two sockets. One either side of the platform

Parasol with offset post with two sockets. One either side of the Fore deck

Teak

Teak Decking for the aft cockpit, side decks and fore peak.

Teak Decking for the aft lower deck platform

Forward facing seating Teak console top on the Fore Deck

Outboard Teak Tables with fixed top and stainless steel legs on the Fore Deck

Teak coffee Tables x two with fixed top and stainless steel legs in the Aft Cockpit

Supply items

Jetski and Tender sliding chocking system

Systems

MAN MMDS Alarm Panel per engine dual station.

Aventics Marex OS 3 Engine propulsion twin control levers dual station.

MAN Start-Stop panel per engine dual station with transponder key on lower console.

MAN MMDS terminal with display per engine in the engine room.

Auto Troll for Transmissions for slow speed manoeuvring

Trailing Pumps. Used to supply oil pressure for gearbox lubrication during wind-milling situations, this may include running on one engine or when under tow. When running on one engine at 10 knots 2800 NM can be achieved (only possible if confirmed at stage of contract and 16 weeks prior to mould)

Hydraulic Slepner Bow thruster system. Model SP550/386TC-BA40 470kg thrust in a 386mm ID GRP tunnel.

Controlled using a Slepner proportional joystick with dual station control.

Engine room access door from Crew cabin. Heavy duty watertight door.

Aft docking station

Aft Docking control station starboard cockpit.

Aventics Marex OS 3 Engine propulsion twin control levers dual station.

MAN Start-Stop panel per engine.

Proportional Bow and Stern Thruster control.

Horn button.

Air Conditioning

Air Conditioning Marine Air chilled water system to standard specification - 195,000 BTU

Fresh water systems

Fresh water tank system using one Polyethylene tank of 1500 litres. WRAS approval for portable water. Pressure system via a self priming pump and mounted with inlet/discharge manifold.

Fresh water marina connection regulator

Freshwater purifiers serving the galley and to all independent icemakers.

Hot water calorifier. 200 litre stainless steel cased tank with 3 x 2kW immersion heaters. 60 litre expansion tank.

Hot water circuit ring main throughout the lower decks with permanently running AC circulation pump.

Hand held swimming shower

Fresh water deck wash system with hose reel and outlets on Aft deck, Flybridge deck and Fore deck

Grey Water Systems

Grey water from showers, wash basins and galley services will drain either directly to the grey tank or via a grey water sump transfer box via a 24Vdc pump into the Grey water holding tank of 1125 litre capacity.

Discharge is via two 24Vdc pump directly over board or via a shore side suction facility through a deck fitting when available.

Black water systems

Black water holding tank system using one tank for main accommodation and crew of 805 litres. Discharge through either 24 Vdc self-priming diaphragm pump directly overboard (refer to MARPOL regulations) or to a shore facility when available.

Tecma Silent Plus 24Vdc macerating toilets

Replace all toilets with the Tecma E-Breeze in lieu of the standard.

Watermakers

Preparation for future installation of a Water Maker. Seacock and outlets blanked off. Fresh water feed to tank. Power supply

Engine room systems

Bilge arrangement is divided into three compartments and monitored by the ships monitoring system and fitted with dedicated float switches.

Accommodation forward - 1 x 24V Rule 2000 duty bilge pump, 1 x 24V Rule 3700 flood bilge pump and 1 x 24V Rule 500 Auto bilge pump.

Accommodation aft - 1 x 24V Rule 2000 bilge pump, 1 x 24V Rule 500 bilge pump and 2 x 24V Rule 500 Auto bilge pumps.

Machinery space - 1 x 24V Rule 2000 duty bilge pump and 1 x 24V Rule 3700 flood bilge pump.

Fire alarm detection system. Control panel with dedicated Discovery Smoke/heat detectors in all accommodation areas. Connected to Cm8 monitoring system to repeat alarm.

Machinery space fire extinguishing system using FK-5-1-12 extinguishing agent. The system is fully automatic incorporating main engine, generator and engine room ventilation shut-down with a mechanical manual over-ride pull in the side deck fire locker.

Diesel fuel

Systems

Two Mase IS27 - 50Hz - 1500 RPM 29kW generators

Sunseeker Cm8 integrated power management, boat monitoring and control system.

Lower helm. 10" Glass Touch screen with full system access touchscreen display.

Fly bridge helm. 10" Glass Touch screen with full system access touchscreen display.

The above touchscreen interfaces allow the control of the following systems.

Automatic AC Power Management.

Two 8kW inverters to provide a regulated and uninterrupted supply to the Audio Visual and air handling systems and to boost generator output. Output Power 2 x 8kVA single phase 230V 50Hz.

Fresh water marina connection regulator

Freshwater purifiers serving the galley and to all independent icemakers.

Hot water calorifier. 200 litre stainless steel cased tank with 3 x 2kW immersion heaters. 60 litre expansion tank.

Hot water circuit ring main throughout the lower decks with permanently running AC circulation pump.

Hand held swimming shower

Fresh water deck wash system with hose reel and outlets on Aft deck, Flybridge deck and Fore deck

Grey Water Systems

Grey water from showers, wash basins and galley services will drain either directly to the grey tank or via a grey water sump transfer box via a 24Vdc pump into the Grey water holding tank of 1125 litre capacity.

Discharge is via two 24Vdc pump directly over board or via a shore side suction facility through a deck fitting when available.

Black water systems

Black water holding tank system using one tank for main accommodation and crew of 805 litres. Discharge through either 24 Vdc self-priming diaphragm pump directly overboard (refer to MARPOL regulations) or to a shore facility when available.

Tecma Silent Plus 24Vdc macerating toilets

Replace all toilets with the Tecma E-Breeze in lieu of the standard.

Watermakers

Preparation for future installation of a Water Maker. Seacock and outlets blanked off. Fresh water feed to tank. Power supply

Engine room systems

Bilge arrangement is divided into three compartments and monitored by the ships monitoring system and fitted with dedicated float switches.

Accommodation forward - 1 x 24V Rule 2000 duty bilge pump, 1 x 24V Rule 3700 flood bilge pump and 1 x 24V Rule 500 Auto bilge pump.

Accommodation aft - 1 x 24V Rule 2000 bilge pump, 1 x 24V Rule 500 bilge pump and 2 x 24V Rule 500 Auto bilge pumps.

Machinery space - 1 x 24V Rule 2000 duty bilge pump and 1 x 24V Rule 3700 flood bilge pump.

Fire alarm detection system. Control panel with dedicated Discovery Smoke/heat detectors in all accommodation areas. Connected to Cm8 monitoring system to repeat alarm.

Machinery space fire extinguishing system using FK-5-1-12 extinguishing agent. The system is fully automatic incorporating main engine, generator and engine room ventilation shut-down with a mechanical manual over-ride pull in the side deck fire locker.

Diesel fuel

Systems

Two Mase IS27 - 50Hz - 1500 RPM 29kW generators

Sunseeker Cm8 integrated power management, boat monitoring and control system.

Lower helm. 10"" Glass Touch screen with full system access touchscreen display.

Fly bridge helm. 10"" Glass Touch screen with full system access touchscreen display.

The above touchscreen interfaces allow the control of the following systems.

Automatic AC Power Management.

Two 8kW inverters to provide a regulated and uninterrupted supply to the Audio Visual and air handling systems and to boost generator output. Output Power 2 x 8kVA single phase 230V 50Hz.

Domestic battery Bank - 8 x AGM domestic batteries located forward complete with 2 x Domestic battery chargers to provided extended running of DC System.

Automatic Control system provides a constant monitoring of power used on all systems and utilises inverters to assist with power management on board."

Air Horns AFI twin trumpet Horn

Shore Power Options

Shore power connection is via 1 x 100 Amp 250 Volt rated plugged flexible cable on a Glendinning cablemaster motorized cable retraction system.

Isolation Transformer 24kVA. Ensures galvanic isolation from shore supply, minimises minor variations in shore supply voltage.

Galley Appliances

Custom Galley Integrated Refrigeration by Frigoboat with stainless steel interior. 250 litres fridge capacity and 120 litres freezer capacity in the Galley

Miele Electric oven in the Galley

Miele Microwave oven

Miele Ceramic hob in the Galley

Miele Extractor fan in the Galley

Miele full size Dishwasher

Miele Wine Cooler for 34 bottles

Crew Appliances

Miele washing machine combined tumble dryer in the Crew Mess

Separate Miele washing machine and Miele tumble dryer in the Crew Mess

Sharp Microwave

Refrigerator 113 Litres with integral Freezer box in the Crew Mess

Flybridge Appliances

Refrigerator 113 litres with integral Freezer box on the Flybridge

Icemaker - Hoshizaki on the Flybridge

Drawer refrigerator with stainless steel front 24V 36 litre capacity on the Flybridge

Marine Electric BBQ kenyon Grill on the Flybridge bar

Marine Electric stainless steel BBQ grill 740mm wide on the Flybridge bar

Aft Cockpit Appliances

Refrigerator 75 litre 24V in the Aft Cockpit

Security

CCTV with 3 Cameras: Stern docking and engine monitoring cameras. Iris S460 Marine High Definition stainless steel dome 3MP IP wide angle docking camera. Built in infra-red LED's operate automatically via a day/night filter to provide illumination up to 10 meters at night and in low light conditions. One for stern docking and two in the engine room.

In addition to the 3 camera CCTV package selected, two additional cameras one on each side with view of the side deck/bulwark. Ceiling mounted cameras facing aft.

Navigation Lights

Halogen navigation lights

Lighting

Lighting switching on momentary push button Vimar switches with Dimmer switches saloon, galley, helm and aft cockpit overhead lighting
Twin Beam remote controlled Searchlight dual station control. 55W x2 Halogen 24V - 160,000cd
Underwater lights Full Colour Changing underwater lights x 10 with colour control on the Simrad MFD. Four across the stern and three either side.
Two Porta Romana Large Covex Wall Lights - TWL92L Bronze in the Master Stateroom
Port Side Desk Lamp - Contardi Athena in the Master Stateroom
Two Porta Romana Pillar Wall Light SWL09 in the Forward VIP Cabin
Two Porta Romana Bishop Lamps GLB79 in the Main Deck Saloon
Bed side wall lamps in the Master Stateroom

Communication Equipment

Standard Network system:
Peplink MAX BR1 Pro 5G router with internal antennas to provide access to the internet via 4/5G Cellular data or Marina Wi-Fi.
The Pro 5G has two SIM card slots. One of these slots will have a SIM card pre-fitted, and should not be removed.
The system will have the benefit of 2 years on-line and telephone support of up to 2 hours, supplied by the UK KVVH distributor, CA Clase Ltd.
The fitted SIM will also allow the client to purchase data and allow the support engineers to access the boat network and troubleshoot problems.
The second SIM slot will allow the client to purchase their own data SIM as required."
Pepwave router to be upgraded to a 5G compatible unit in lieu of the standard 3G/4G.
Cellular and WiFi signal booster antennas

Simrad standard package

Main Console.
Two Simrad NSO Evo3S 19" Displays and OP50 keypad controller.
10" touchscreen controlling the Sunseeker monitoring.
Simrad Halo 2004 Pulse Compression Radar 4ft 64nm.
Simrad GS25 GPS Antenna.
Simrad Autopilot AP44 system.
Simrad xSonic ss60 stainless steel broadband Dual frequency 50kHz-200kHz shallow and bottom tracking depth and temperature transducer.
Simrad HS100 VHF with DSC. 2.4M whip VHF antenna.
Richie Helmsman HF-743B Flush Mount Magnetic Compass.

Flybridge Console.

Two Simrad NSO Evo3S 16" Display.
10" touchscreen controlling the Sunseeker monitoring
Simrad Autopilot AP44 system.
Simrad HS100 second station VHF with DSC.
Richie Helmsman HF-743W Flush Mount Magnetic Compass.

Console items

Compass Swinging and adjustment with correction card

Performance AV package

1. Saloon Samsung 65" QLED 4K Smart Television on an electric pivot hinge bracket. Sonance Soundbar and Sonos Amp. Rear Sonance speakers with Sonos Amp and a Sonos Subwoofer. Two additional Dining area Sonance speakers with a Sonos Amp. Two additional Helm and Observation area Sonance speakers with a Sonos Amp.
 2. Master Stateroom Samsung 55" QLED 4K Smart Television. Surround sound system with Proficient Soundbar and Sonos Amp. Rear Sonance speakers with Sonos Amp and a Sonos Subwoofer. En-suite Sonance speaker with a Sonos Amp.
 3. Forward VIP cabin Samsung 55" 4K Smart Television. Proficient Soundbar and Sonos Amp. Rear Sonance speakers with Sonos Amp and a Sonos Subwoofer.
 4. Aft port and starboard Guest cabins Samsung 55" 4K Smart Television. Proficient Soundbar and Sonos Amp.
 - 5 Aft Cockpit zone audio with four Sonance 8" Speakers with Sonos Amp.
 - 6 Beach Club platform zone audio with two Sonance 6.5" Speakers with Sonos Amp.
 - 7 Flybridge deck zone audio with eight Sonance 8" Speakers with Sonos Amp.
 - 8 Fore deck zone audio with four Sonance 6.5" Speakers with Sonos Amp.
- The zoning audio to be linked via the Sonos App with one tablet supplied for control of the zones.

Supply Items

- Retractable boat hook
- 6x Docking lines. 15 metre x 20mm 3 strand black with eye on one end
- 1x Tender line. 10 metre x 10mm 3 strand black
- 8x Fenders Majoni Mega F7, 35 x 110 cm in white
- 8x Fender ties. 3.5 metre x 12mm 3 strand black
- Hand held LED inspection lamp
- Basic small tool kit
- 8x Guest Towel sets
- 4x Crew Towel sets
- Basic First Aid Kit
- Fire Blanket. Ocean Safety FIR0022. 1.1 x 1.1 M
- 9x Portable dry powder fire extinguisher 1kg 5A 34B C
- Leather Cleaning Kit
- RINA Fire bucket 3 gallon with line
- Portable Hose Reel
- 2 x Deckwash connectors
- Mosquito screens for openable portlights

Upgrade

- Manutti Outdoor Luxury Furniture

